

COX BUSINESS CONVENTION CENTER

A TULSA ORIGINAL SINCE 1964







COX BUSINESS CONVENTION CENTER

COX BUSINESS CONVENTION CENTER

Located in the Arena District in downtown Tulsa, Cox Business Convention Center (CBCC) is a modern and award-winning venue providing over 275,000 SF of flexible event space, including Oklahoma's largest banquet space (41,470 SF). CBCC offers in-house catering and AV/IT.

HOTEL



2,000+
hotel rooms within walking distance of CBCC

15
downtown hotels

TULSA INTERNATIONAL AIRPORT

3 million+ travelers pass through TUL yearly on flights serving 24 destinations

15
minutes from CBCC

22
nonstop destinations including new nonstop flights to Orlando International Destin-Ft. Walton, and Washington - Reagan.

11
unique districts in downtown Tulsa

70+
diverse restaurants in one mile radius of CBCC

1 million+
people in the Tulsa Metropolitan Area

GATHERING PLACE
Best City Park, 2021 according to USA Today

100
acres upon completion

EVENTS



Oklahoma Comic Con
10,000 attending



Bassmaster Classic 2024
107,000 attending



Oklahoma FFA Convention
15,000 attending

WHITewater RAFTING PARK
Opening 2024

30
acre park

1200 ft
long channel

8
drop features

EXPLORE THE CBCC HERE
coxcentertulsa.com



DOWNTOWN TULSA

1.93M

ANNUAL VISITORS

34K

EMPLOYEES
DOWNTOWN

3RD

BEST CITY FOR
REMOTE WORKERS

24%

GROWTH IN
TECH EMPLOYMENT

15

HOTELS
DOWNTOWN

2320

HOTEL ROOMS
DOWNTOWN

110+

RESTAURANTS
AND BARS

7

JAMES BEARD
NOMINEES

95%

LOCALLY OWNED
STREET LEVEL BUSINESSES

15+

ACRES OF
PARK SPACE

8

MUSEUMS
DOWNTOWN

#1

FOOD HALL IN
AMERICA ACCORDING TO
USA TODAY

GETTING TO CBCC

DRIVE TIMES TO TULSA



- 4 HRS** DALLAS
- 4 HRS** KANSAS CITY
- 10 HRS** DENVER
- 10 HRS** CHICAGO

15/9
MIN MI

FROM CBCC

27%

INCREASE IN PASSENGERS
YEAR-OVER-YEAR

22

NONSTOP DESTINATIONS

NON-STOP ROUTES TO TUL

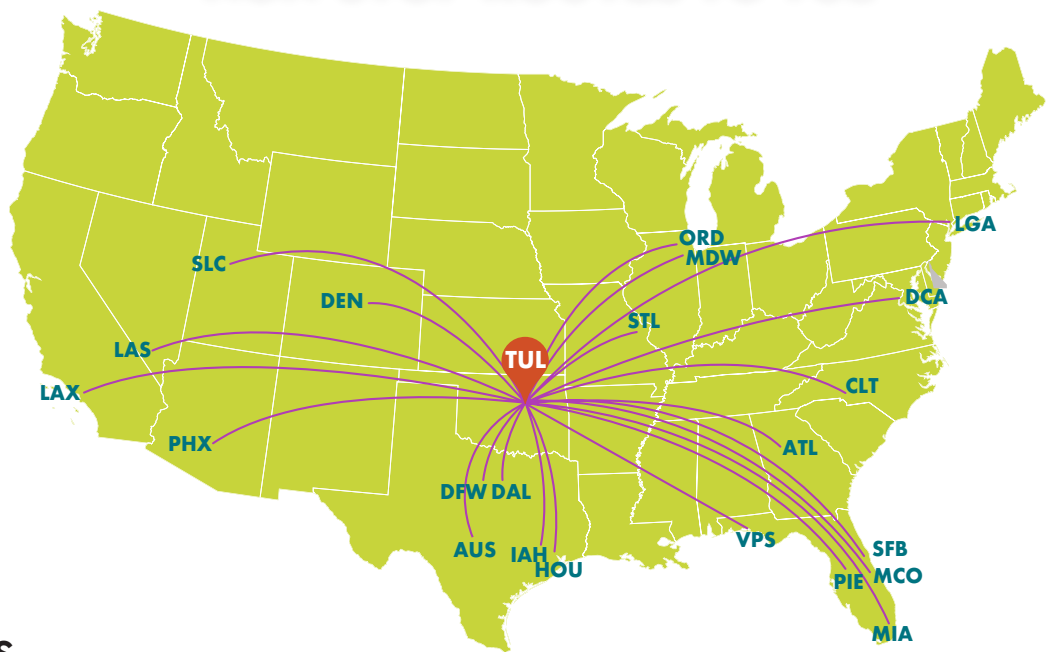

CNN TRAVEL

Tulsa is the **only American city** listed on *Where to Travel: The Best Destinations to Visit*



TRAVEL PULSE

Listed Tulsa among **Affordable U.S. Travel Destinations for 2024**

Greenwood Rising listed as one of the **Best Art Exhibits of 2023**

THE NY TIMES

Tulsa is rated **No. 1** among **Top 10 Best U.S. Cities for Young Entrepreneurs**

NERDWALLET



"Not everything that is faced can be changed, but nothing can be changed until it is faced."
- JAMES GALBRAITH



15 HOTELS
DOWNTOWN

110+ RESTAURANTS
AND BARS

2320 HOTEL ROOMS
DOWNTOWN

10K PARKING SPACES
NEARBY



BOK

ATLAS LIFE

AVERAGE MENU PRICE PER STYLE OF SERVICE

BREAKFAST

Includes water, regular and decaf coffee service. Plated includes tea selection. Continental and buffet have two-hour service time.

CONTINENTAL

The Early Riser

\$16.50

PLATED

The Southwestern

\$19.50

BUFFET

American Diner Breakfast

\$23

LUNCH

Includes water, iced tea and coffee service. Plated entrées include choice of dessert. Salad available for additional cost.

BOX LUNCH

Deli Meat and Cheese Wrap

\$19

PLATED TWO COURSE

Parmesan Crusted Chicken Breast, Italian Tiramisu Torte

\$30

BUFFET

The Backyard Buffet

\$34

DINNER

Includes water, iced tea and coffee service. Plated entrées include choice of salad and dessert.

PLATED ENTRÉE

Pan-Fried Chicken Breast, Southern Salad, Bourbon Street Pecan Pie

\$46

PLATED DUO ENTRÉE

Italian Chianti Braised Short Rib & Oreganato Chicken Breast, California Heritage Field Greens, Callebaut Flourless Chocolate Torte

\$60

BUFFET

American Farmer's Market

\$48



COFFEE
\$46/GALLON

**Prices are subject to change without notice and are exclusive of current sales taxes (8.517%), beverage taxes (13.5%) and administrative fee (24%).*



CHEF DEVIN LEVINE

Executive Chef Devin Levine, CEC, has cooked for some of the most famous and influential music artists, professional athletes, and U.S. presidents. Known for his "classic comfort cuisine with a modern twist," Chef Levine offers over 40 years of culinary experience and loves to create custom seasonal menus uniquely tailored for your event. Chef Levine is a 50 year member in good standing with the American Culinary Federation, completing the 3 year A.C.F.E.I. apprenticeship program from 1976–79, obtaining his certified Chef de Cuisine status in 1985 and Certified Executive Chef status in 1990 and recertifying every five years since. Chef Levine is currently Chairman of the Board for the ACF Tulsa Chapter.



CHEF SARAH LEAVELL

Executive Sous Chef Sarah Leavell is an avid participant in culinary competitions most notably winning the Oklahoma Restaurant Association Culinary Cup Competition and representing Oklahoma twice in the Chaine des Rotisseurs young chef southwest regional competition. Chef Leavell serves on the Indian Capital Culinary Program Advisory Committee, OSU-IT Culinary Program Advisory Committee and the Nathan Hale High School Culinary Advisory Committee. Chef Leavell has been involved with several ProStart culinary and has also been giving back to local Girl Scout Troops for several years now.

SOCIAL STATS



2,195

INSTAGRAM FOLLOWERS
@COXCENTERTULSA

REELS
50.3K

POSTS
25.6K

VIDEOS
6,755

STORIES
4,332

1.87M

PEOPLE REACHED



10,635

FACEBOOK FOLLOWERS
@COX BUSINESS CONVENTION CENTER

PAGE VISITS
46.9K

MONTHLY ENGAGEMENT
5.7K

NEW LIKES & FOLLOWS
1,016



352

TIKTOK FOLLOWERS
@COXCENTERTULSA

VIEWS
57.1K

LIKES
4,092

SHARES
193



552,380

WEBSITE PAGE VIEWS
COXCENTERTULSA.COM

156K

SESSIONS

INSIGHTS

BOUNCE RATE
.93%

AVG DURATION
1M 13S

**A YEAR
IN REVIEW**

MARKETING ASSETS

Cox Business Convention Center marketing offers publicity through our indoor monitors, CoxCenterTulsa.com's event calendar, and the possibility of social media posts, additional signage, activations inside the venue, downtown area and Tulsa International Airport.

One of our favorite things to do in Tulsa is to extend a warm welcome to upcoming large-scale events, ensuring a seamless and enjoyable experience for all guests. From the moment attendees arrive at our airport, they will be greeted with efficiency and hospitality, setting the tone for a positive visit followed by an atmosphere at CBCC that reflects the warmth of our city.

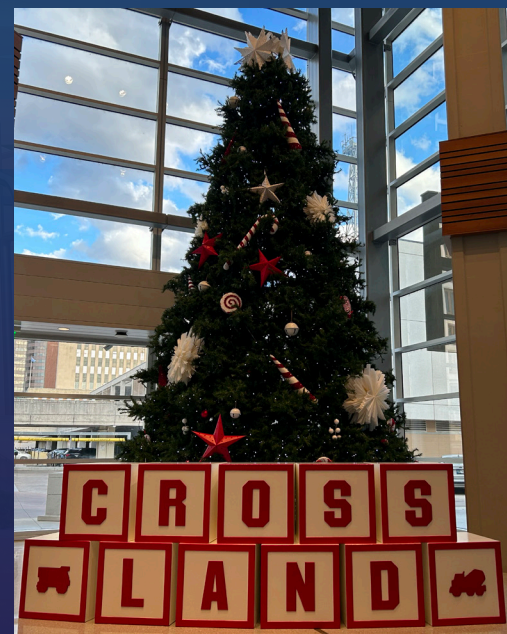
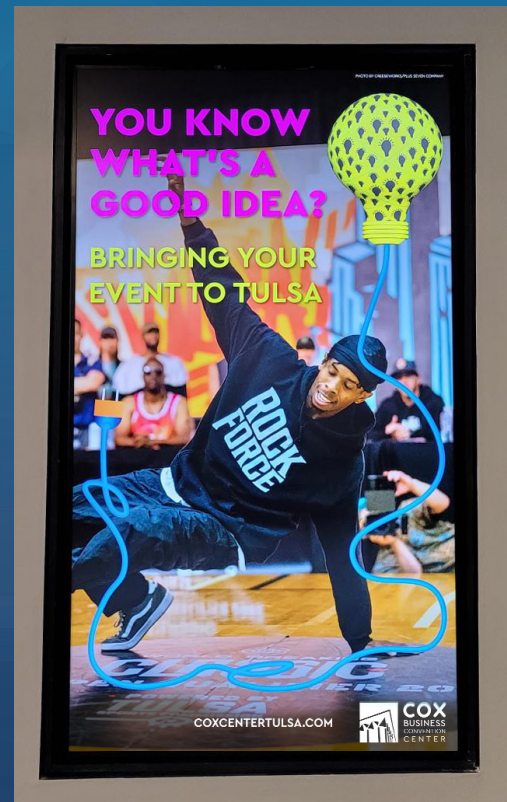

WHAT THE CLIENTS SAY

“ We are here for several events per year and the treatment that we get, the love that we get, the service that we get, that amazing partnership of family and delivery of service is unparalleled. ”

*Melanie Bradshaw
SeneGence International, Inc.*



“ The new event space is amazing! From the very beginning of our planning process to the very end, the staff and crew were great to work with. ”

*Lany Milner
Associated General Contractors of Oklahoma*

“ Cox Business Convention Center checks all the boxes for us. The flexibility of the space and downtown location are perfect for our event. We especially love the staff, their attention to detail, the creativity they bring to our menus and the pride that they take in ensuring a positive experience for our participants. ”

*Karen LaPlante
Mental Health Association Oklahoma*

READY TO SEE WHAT THEY'RE TALKING ABOUT?
coxcentertulsa.com/planner-resources



TULSA BALLROOM + GALLERY + WEST MEETING ROOMS

WEST MEETING ROOMS

Left to Right:

Riverside

1. Riverside
2. Utica
3. Boston
4. Blue Dome
5. Brookside
6. Cherry Street
7. Greenwood

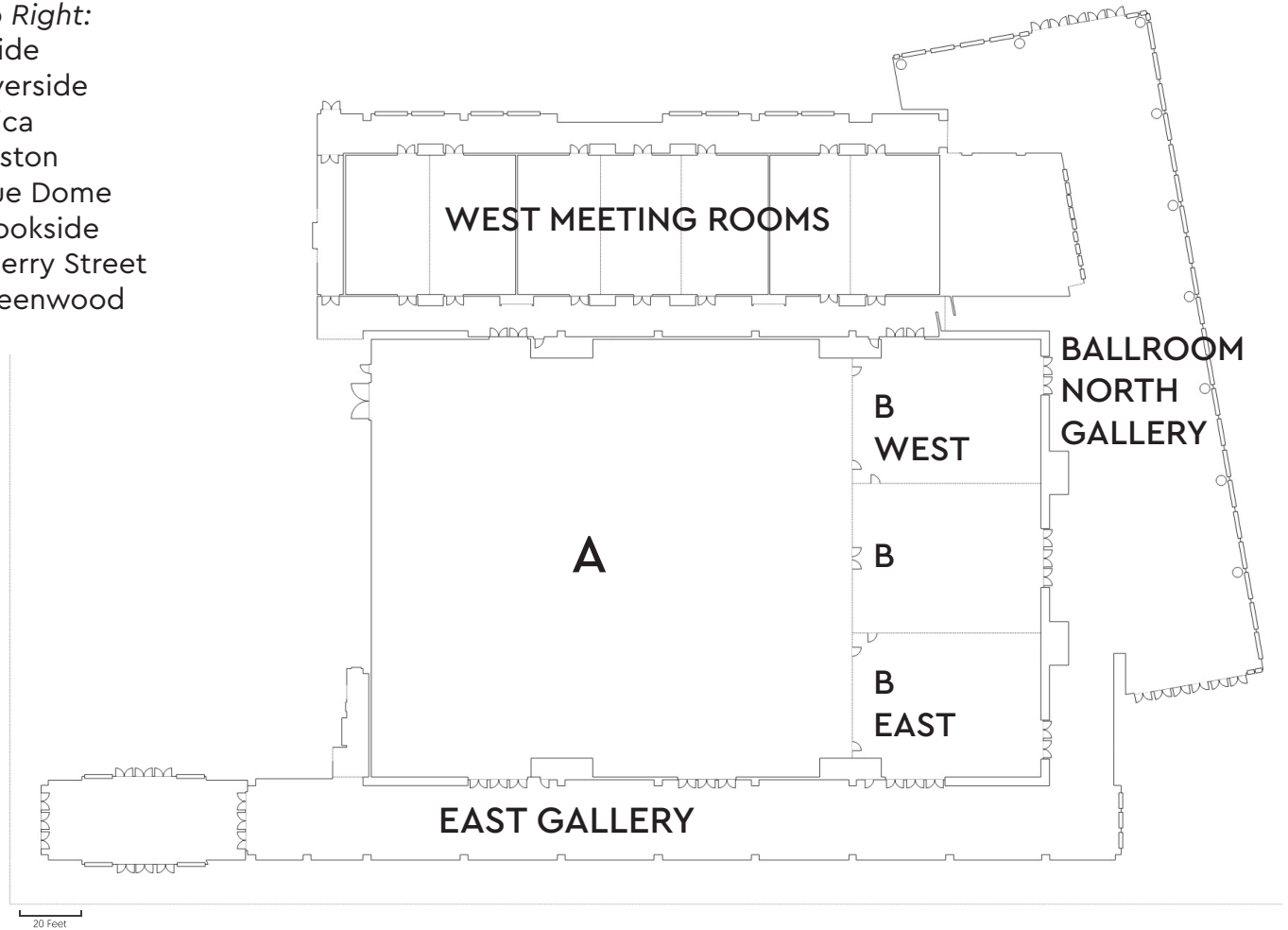

	DIMENSIONS	CEILING	THEATER	BANQUET	CLASSROOM	EXHIBIT*
ENTIRE	216'x142' / 30,060 SF	25'	2,970	1,476	1,170	171
BALLROOM A	155'x142' / 21,474 SF	25'	1,800	990	765	134
BALLROOM B	61'x142' / 8,586 SF	25'	630	288	180	32
B2	61'x48' / 3,098 SF	25'	252	108	81	11
B1, B3	61'x46' / 2,749 SF	25'	180	90	72	11
WEST ROOMS	45'X27' / 1,215 SF	14'	150	60	45	-
GALLERY NORTH	4,524 SF usable		567	302	378	45
GALLERY EAST	2,367 SF usable		295	157	197	23

**Banquet 10 seats per table / Classroom 3 seats per table / Exhibit 10' x 10'*

All dimensions and figures are approximate and may vary due to event production specifics and/or venue design developments.



TULSA BALLROOM HIGHLIGHTS

OPTION TO BE SELF-CONTAINED CONFERENCE SPACE WITH SEVEN BREAKOUTS

RIGGING SYSTEM INSTALLED

DMX CONTROLLABLE HOUSE LIGHTING SYSTEM

FLOOR TO CEILING GLASS PRE-FUNCTION GALLERY SPACE

UNIQUE ELATION® FULL COLOR ANIMATED LIGHTING IN PUBLIC SPACES

BACK OF HOUSE GREEN ROOM

COMPLETE PRODUCTION AND AC POWER SUPPORT



PEPSI EXHIBIT HALL + MAIN GALLERY

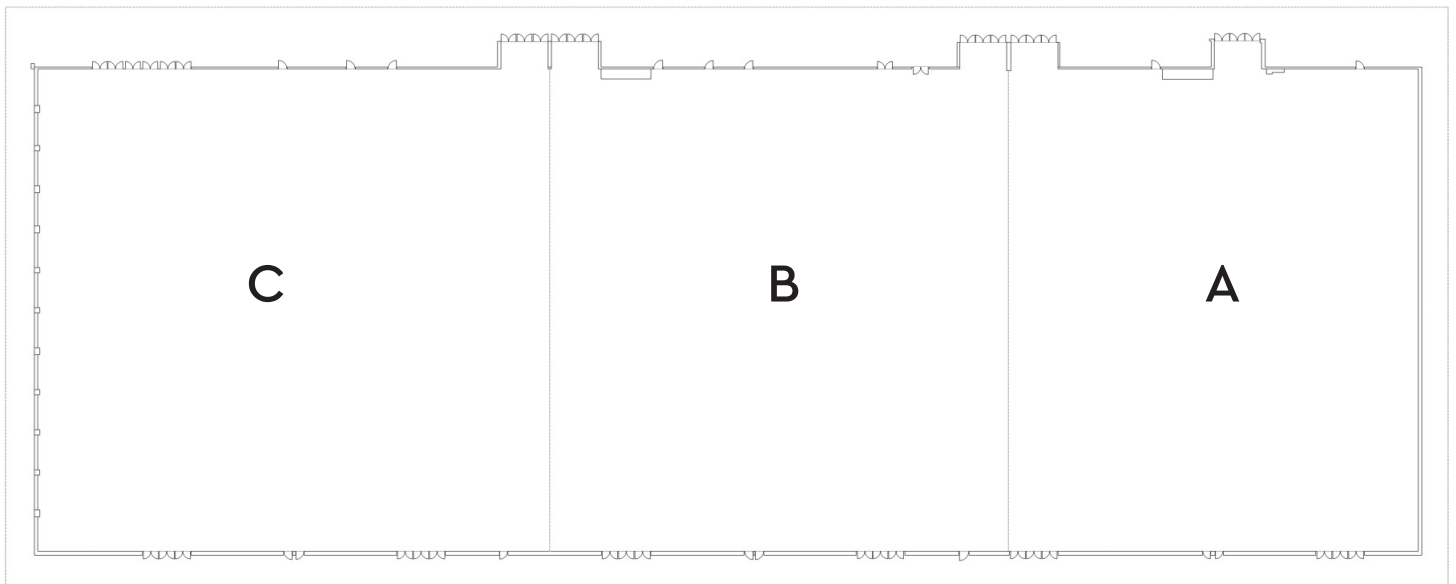
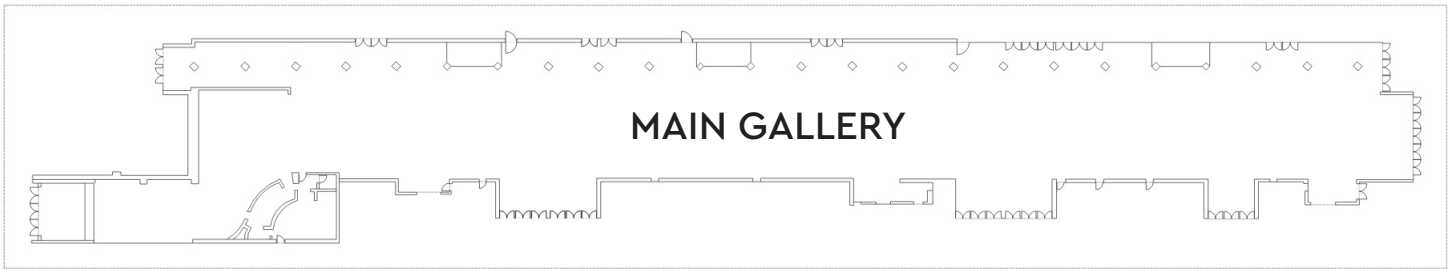

	DIMENSIONS	CEILING	THEATER	BANQUET	CLASSROOM	EXHIBIT*
HALL A, B, C	190'x540' / 102,600 SF	33'6"	6,300	4,374	2,770	459
HALL A	190'x160' / 30,400 SF	33'6"	2,430	1,260	945	135
HALL B	190'x180' / 34,200 SF	33'6"	2,610	1,458	1,037	149
HALL C	190'x200' / 38,000 SF	33'6"	3,060	1,458	1,350	162
MAIN GALLERY	22,700 SF					

**Banquet 10 seats per table / Classroom 3 seats per table / Exhibit 10' x 10'*



All dimensions and figures are approximate and may vary due to event production specifics and/or venue design developments.

Cox Business Convention Center (CBCC)
100 Civic Center, Tulsa, OK 74103 - CoxCenterTulsa.com



PEPSI EXHIBIT HALL HIGHLIGHTS

COLUMN FREE

HOUSE LIGHTING FROM MULTIPLE CEILING FIXTURE SOURCES

ROOM-WIDE PAGING SYSTEM

HIGH CAPACITY WEIGHT LIMIT FLOORS

12 LOADING BAYS

OVERHEAD UTILITIES MEAN NO FLOOR POCKETS

INDUSTRIAL-SCALED 120/208/240 AC POWER DELIVERY



GRAND HALL + GRAND GALLERY

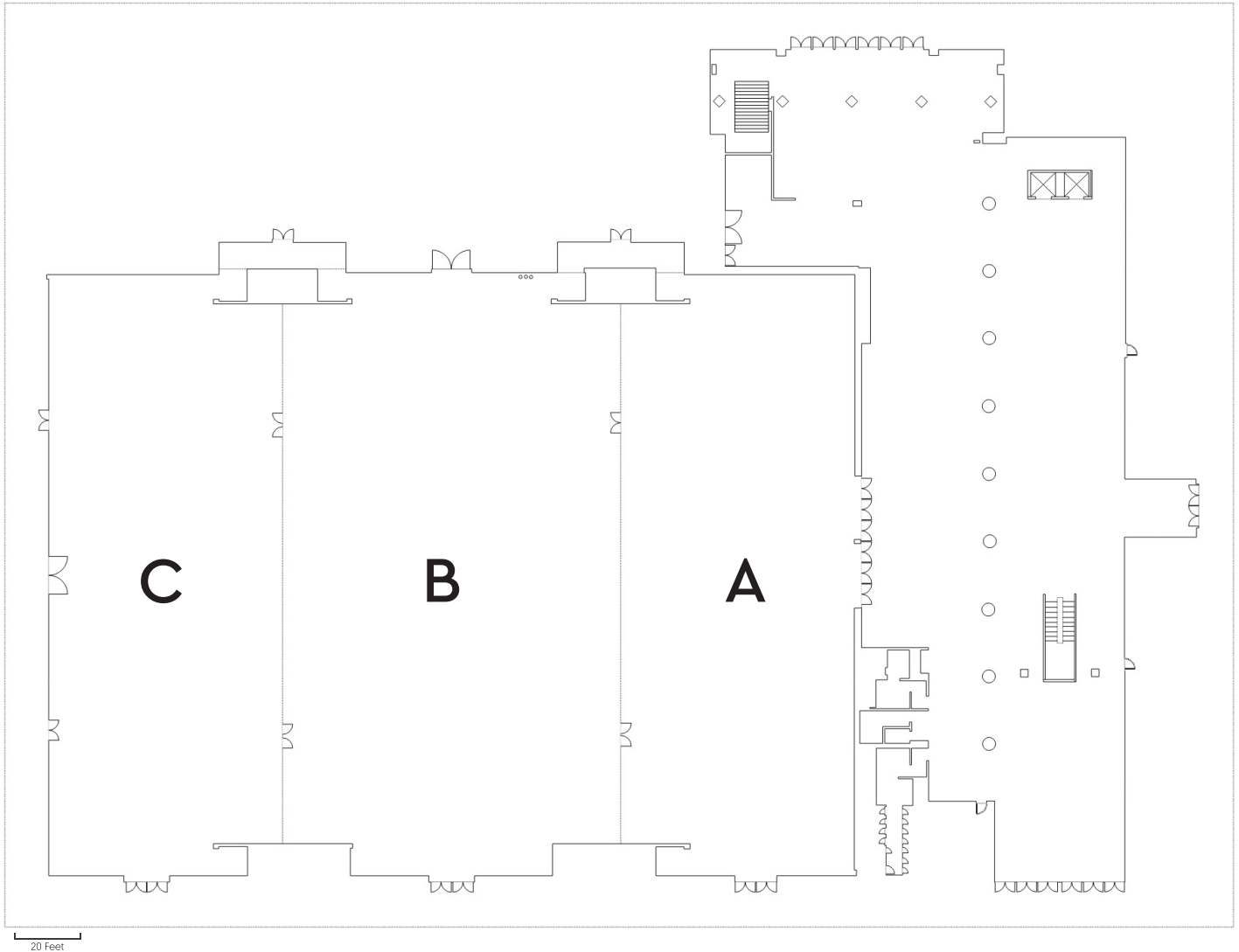

	DIMENSIONS	CEILING	THEATER	BANQUET	CLASSROOM	EXHIBIT*
GRAND GALLERY	4,800 SF	3 STORIES	600	200	130	20
GRAND HALL	177'x238' / 41,470 SF	36'	3,850	2,460	2,082	220
GRAND HALL A	177'x69' / 12,108 SF	36'	1,120	710	594	52
GRAND HALL B	177'x99' / 17,254 SF	36'	1,610	1,040	894	78
GRAND HALL C	177'x69' / 12,108 SF	36'	1,120	710	594	52

**Banquet 10 seats per table / Classroom 3 seats per table / Exhibit 10' x 10'*

All dimensions and figures are approximate and may vary due to event production specifics and/or venue design developments.

Cox Business Convention Center (CBCC)
100 Civic Center, Tulsa, OK 74103 - CoxCenterTulsa.com



GRAND HALL HIGHLIGHTS

LARGEST SPACE OF ITS KIND IN OKLAHOMA

DIVISIBLE INTO THREE SPACES

FULL COLOR LED CEILING LIGHTING SYSTEM THROUGHOUT ROOM

SHOW AND CONCERT POWER

RIGGING ACCESSIBILITY WITH MASSIVE LOAD CAPACITY

TWO LOAD IN/OUT LOCATIONS

TWO-STORY WINDOW TO LET IN NATURAL LIGHT



CONFERENCE HALL

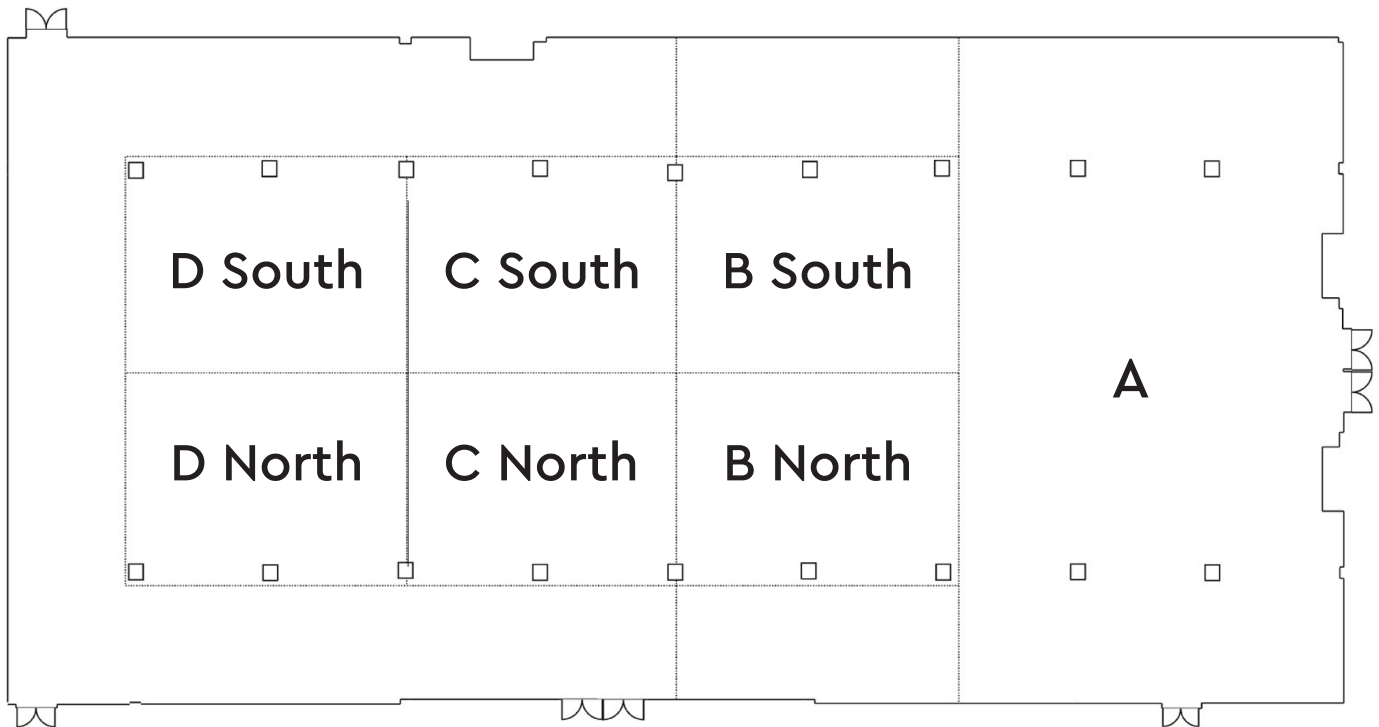

	DIMENSIONS	CEILING	THEATER	BANQUET	CLASSROOM	EXHIBIT*
ENTIRE HALL	100'x200' / 20,000 SF	11'6"	1,305	909	454	86
HALF HALL	100'x100' / 10,000 SF	11'6"	682	477	211	38
HALL A	100'x60' / 6,000 SF	11'6"	443	252	97	22
HALL B, C, or D	60'x40' / 2,400 SF	11'6"	300	125	81	16

**Banquet 10 seats per table / Classroom 3 seats per table / Exhibit 10' x 10'*



All dimensions and figures are approximate and may vary due to event production specifics and/or venue design developments.

Cox Business Convention Center (CBCC)
100 Civic Center, Tulsa, OK 74103 - CoxCenterTulsa.com



CONFERENCE HALL HIGHLIGHTS

MEETING ROOM ZONES FEATURE INDEPENDENT AUDIO AND LIGHTING CONTROL

HIGHLY FLEXIBLE AIRWALL SYSTEM WITH SEPARATE ENTRANCES

PAIRED XLR AUDIO CONNECTIONS IN EACH ROOM ZONE

IDEAL LOCATION FOR BREAKOUTS WITH PROXIMITY TO LARGER EVENT SPACES

CENTRAL PRODUCTION CONTROL ROOM



LEGACY HALL + GALLERY + EAST MEETING ROOMS

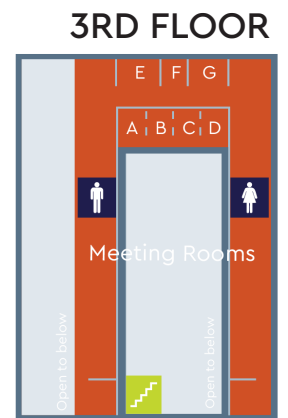
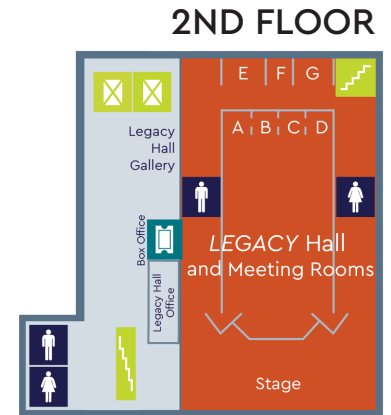
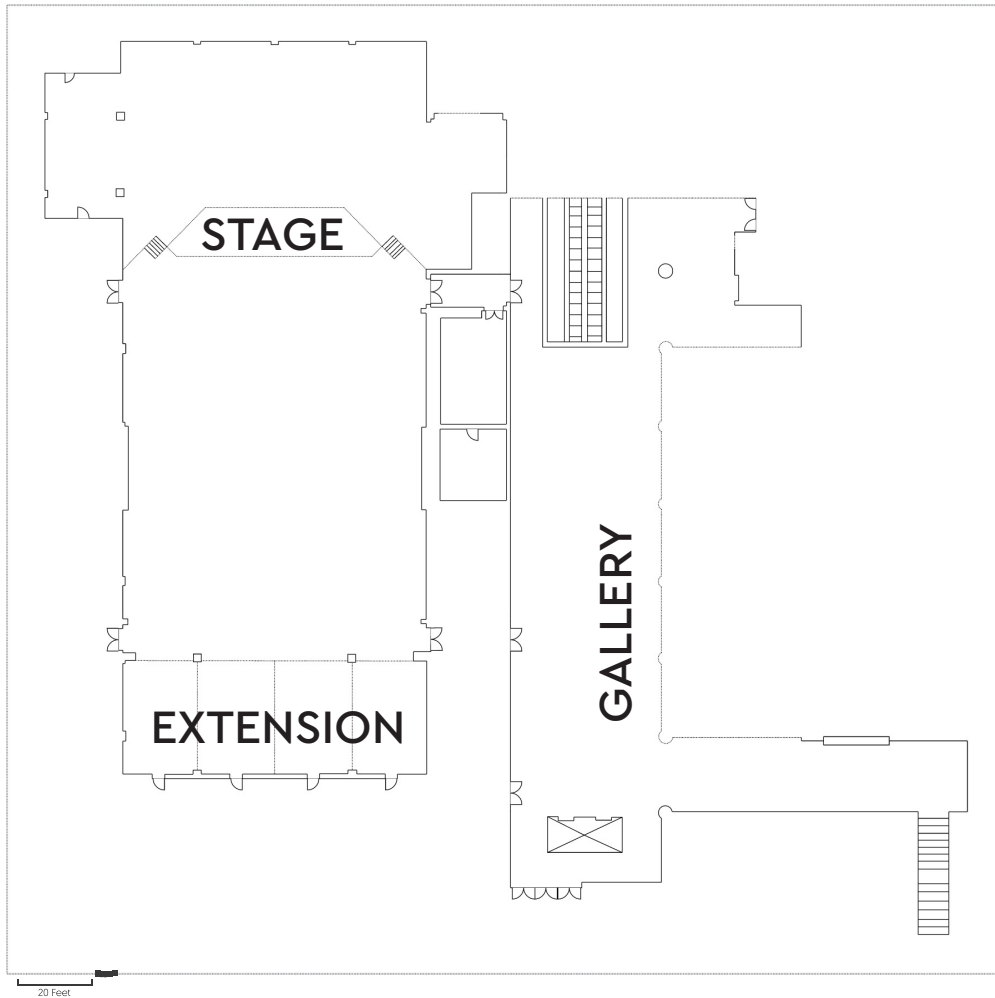

	DIMENSIONS	CEILING	THEATER	BANQUET	CLASSROOM	EXHIBIT*
LEGACY (Entire)	77'x100' / 7,700 SF	21'	900	403	259	36
LEGACY w/Extension	77'x130' / 10,010 SF	10' under extension	1,058	511	324	42
LEGACY Gallery	38'x125' / 4,750 SF					

**Banquet 10 seats per table / Classroom 3 seats per table / Exhibit 10' x 10'*

	DIMENSIONS	CEILING	THEATER	BANQUET	CLASSROOM	EXHIBIT*
A-E or G	20'x30' / 600 SF	10'	176'/ABCD, 44' each E or G, 56 each	27	16	-
F	20'x20' / 400 SF	10'	27	27	16	-

**Banquet 10 seats per table / Classroom 3 seats per table / Exhibit 10' x 10'*

All dimensions and figures are approximate and may vary due to event production specifics and/or venue design developments.

Cox Business Convention Center (CBCC)
100 Civic Center, Tulsa, OK 74103 - CoxCenterTulsa.com



LEGACY HALL HIGHLIGHTS

THEATRICAL STAGE – 50'x40' AND STAGE LEFT AREAS

HOUSE AND STAGE THEATRICAL LIGHTING SYSTEM

THEATER SOUND SYSTEM

DECOR LIGHTING WITH WALL LED COLOR HIGHLIGHTERS

WALL PRESETS WITH DECO-INSPIRED CHANDELIERS

TWO DRESSING ROOMS AND OFFICE

EQUALLY GREAT AS LARGE BREAKOUT OR MID-SIZED BANQUET SPACE



3rd Street

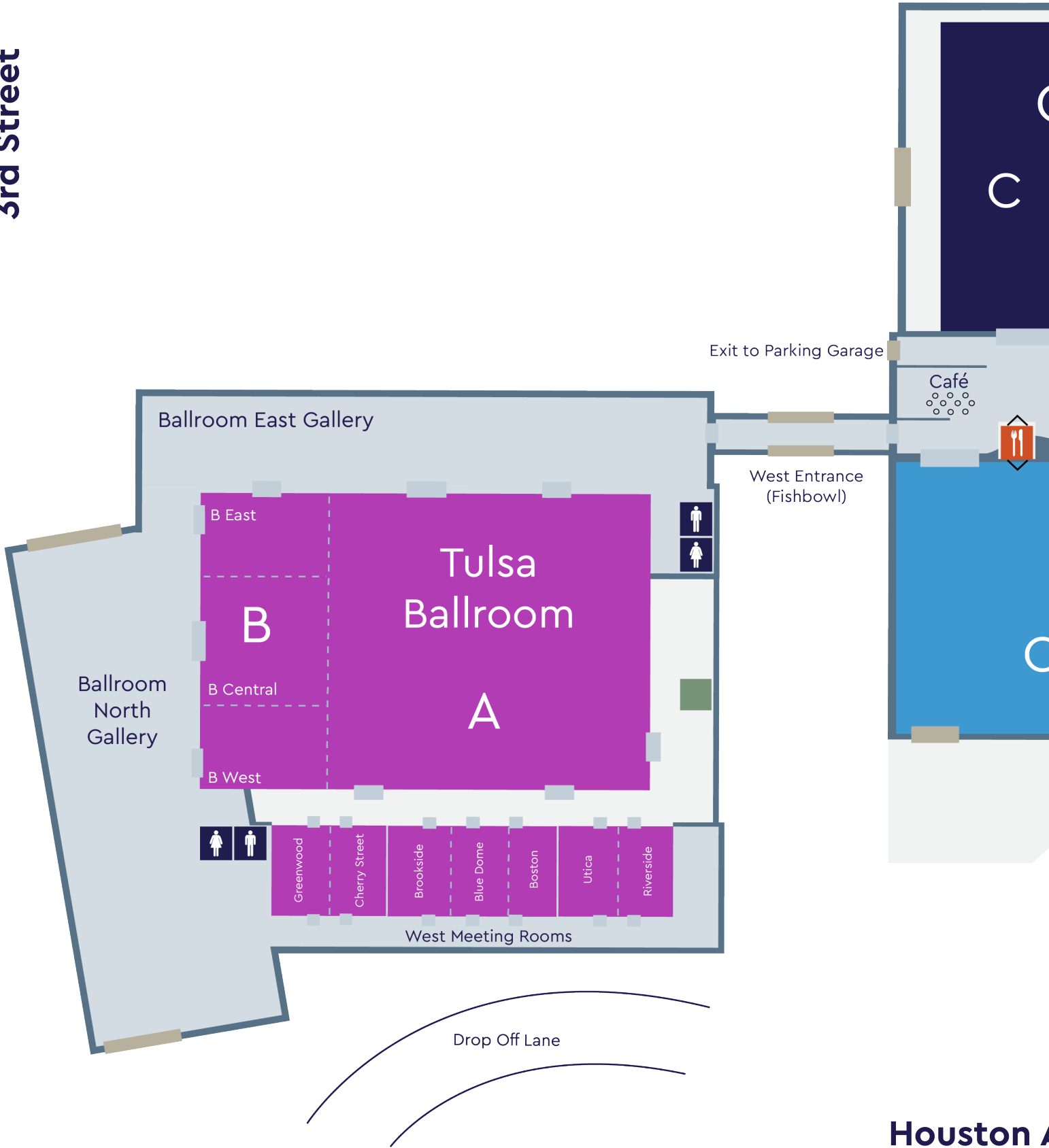

Center

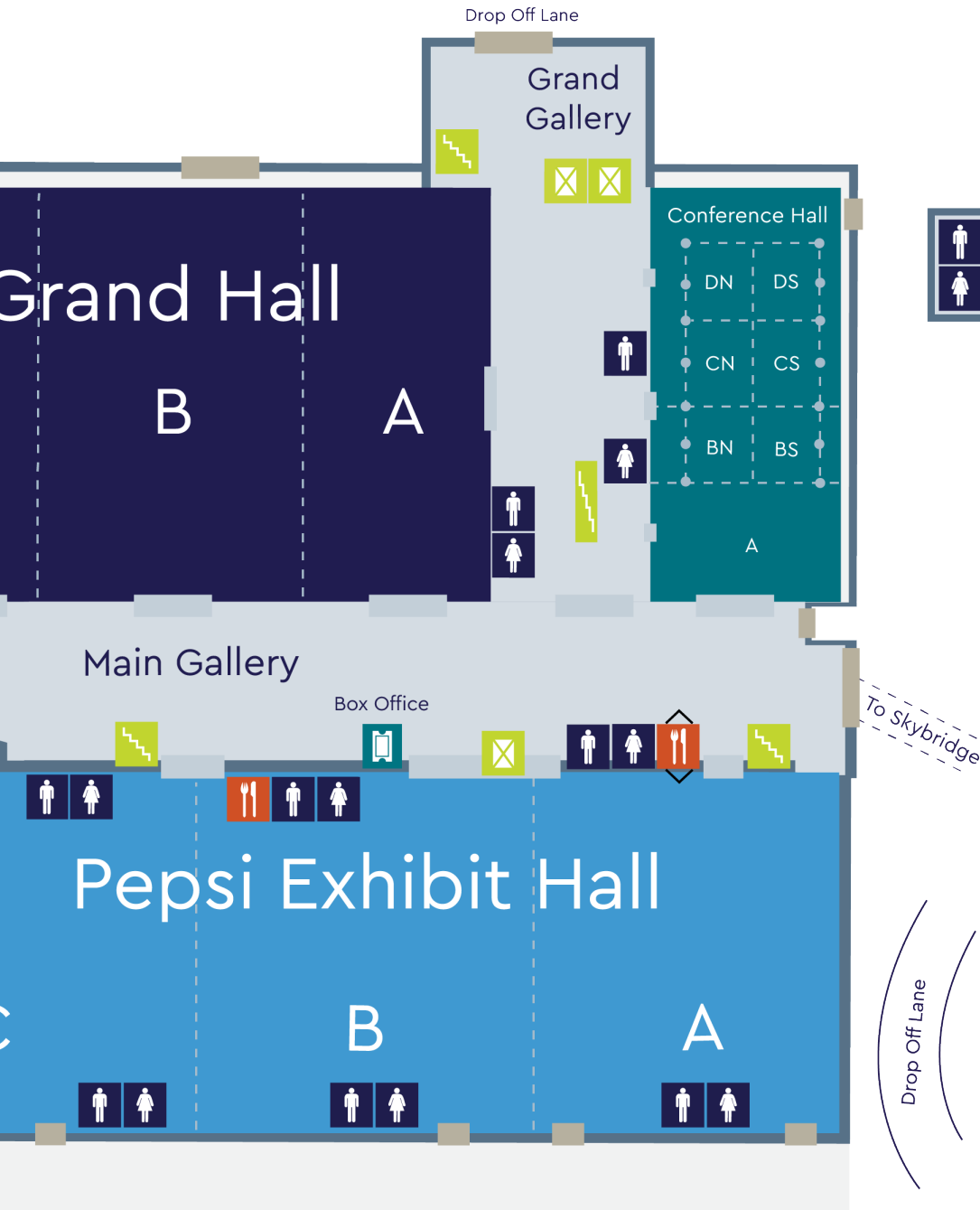

Second Level (Above Conference Hall)

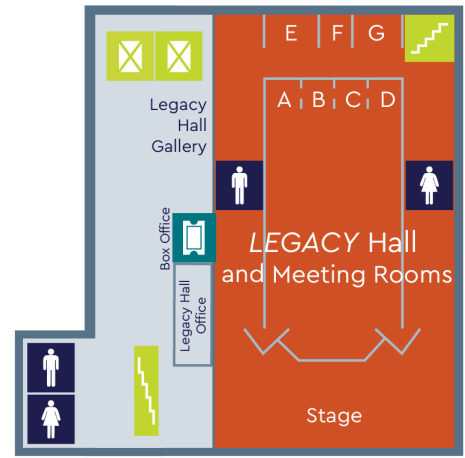

Third Level (Above Conference Hall)

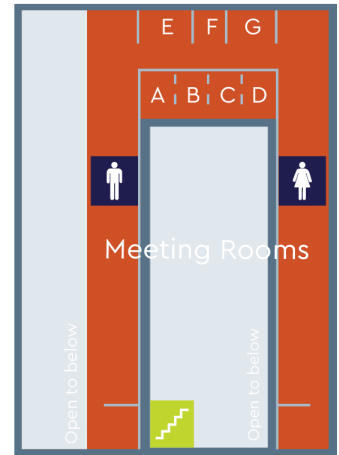

To Skybridge

Drop Off Lane

7th Street

Avenue

MEET THE SALES TEAM



Chas Emerson

Sales Manager

Corporations and Associations

918.894.4261

chas.emerson@oakviewgroup.com



Kathy Tinker, CMP

Sales Manager

Faith-Based and Non-Profits

918.894.4260

kathy.tinker@oakviewgroup.com

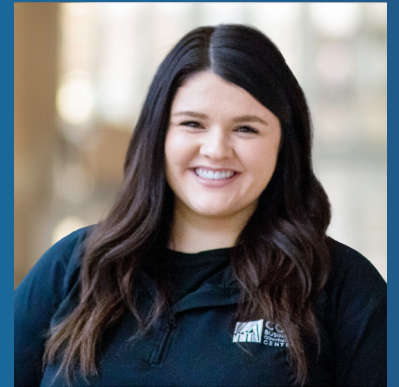

Miranda Duncan

Sales Manager

Sports and Government

918.894.4644

miranda.duncan@oakviewgroup.com



Michele Blackwood

Director of Sales

Citywide Events and Trade Shows

918.894.4275

michele.blackwood@oakviewgroup.com

SEND US YOUR RFP



COXCENTER.TULSA.COM